

**Planning Commission Public Hearing  
for Rezone of Suchner property  
August 29, 2022**

Those present: Adam Bronkema, Chair, Polly Peyerk, Rob Cochran, Lani White, & Keri Viers, Bd. Liason.

Audience: (see attached)

Chair called hearing to order at 10:02am.

Minutes read from last 2 meetings.

Parcel # 027-003-30, is in question. Lani showed map around with specific request. (attached #2)

Public comment:

C. Riker: Why Commercial? What would it entail?

C. Suchner: Vineyard sits to east. Tasting room with 3 rental cottages.

Riker: Size of tasting room?

Suchner: 3,000 sq. ft. probably. Operation to run til November, probably.

Would like to make wine on site. We would be open for public tours.

Dale Quattrin: What is allowed in Commercial Zoning?

Brief explanation.

Mike Taylor: The grapes out there now are enough, or will grapes be trucked in?

Suchner: When fully mature, current yield will be 10, 000 bottles.

Question: How many rooms in cottages?

Answer: 2 bed.

Polly Peyrek: How will the Twp. benefit from this?

Answer: One, the rentals would be up to code. Put those people from trailers in safe code homes.

Suchner: the tax base <sup>will</sup> go up.

Beth Beson: are we talking about rentals today?

Bronkema: talking about total use of this property; wine-tasting, rental units, agriculture additon.

Keri Viers: wine-tasting is not on this piece, only rentals?

Quattrin: are there permits & licenses from the State?

August 29th<sup>h</sup> 2022. Planning Commission Meeting 10:00 am

Call to order

Attendance

Review of minutes from last meeting

Approval of minutes

Business at hand:

1. ✓ Suchner zoning application Public Hearing *- Chris needs zoning*
2. Discussion of proposed Master Plan *(compare/contrast 2005 + 2022)*

New Business

Open forum from public.

Adjourn Meeting

Attendance

Byrne Public Hearing - 8/29/22

Daniel Nelson

DALE QUATTRIN

Mike Taylor

Chris Johnson

Tom WYBRANOWSKI

Sam Curtis

Cindy Pickett

Beth Beson

Brydie Phillips

Steve Bannum

Michelle Reynolds

# T.38-39-40N.-R.2-1W.-1E.

Refer to page 93 for keyed parcels

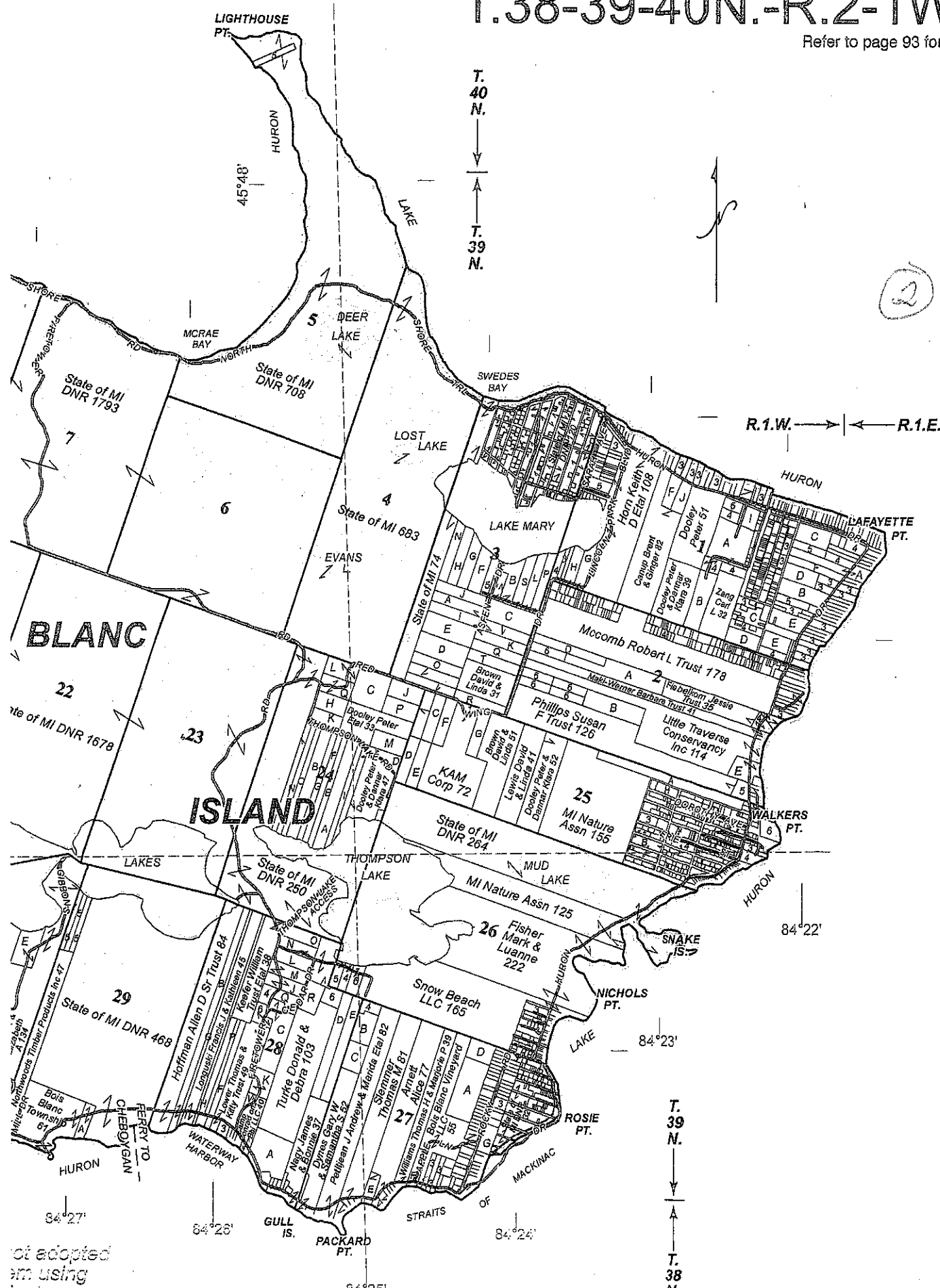

2

R.1.W. ← | → R.1.E.

T. 40 N.  
↓  
T. 39 N.

T. 39 N.  
↓  
T. 38 N.

not adopted  
am using